

Simulation of Thermal Environment in an Office

Case Study of scSTREAM

Simulation of one floor in a building with scSTREAM

Analysis Model Overview

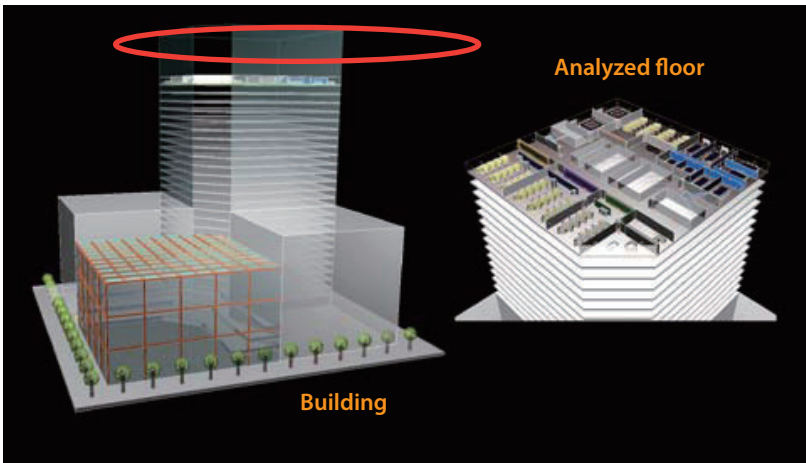

Detailed Floor View (Analysis Region) Vector

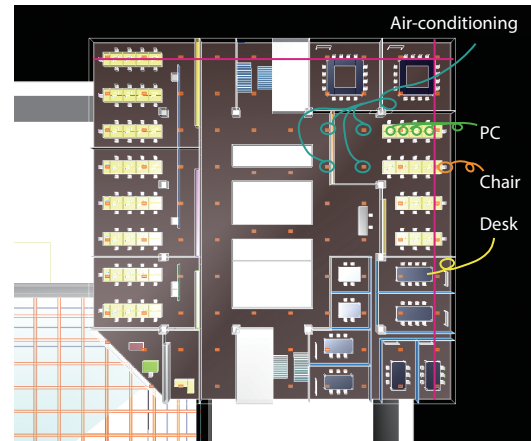

Analysis Results

Temperature Contour

Visualizes temperature contour on arbitrary cut plane
Shows three-dimensional temperature distribution in the office

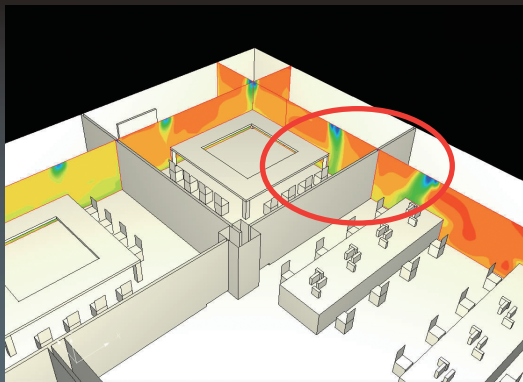

Advantage of CFD

CFD (Computational Fluid Dynamics) helps decrease modification of layouts before construction and accomplish designing facilities effectively in a short period.

Velocity Vector

Visualizes direction of the velocity by arrowhead

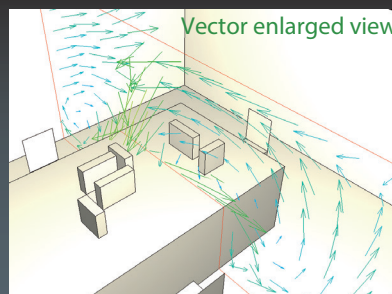
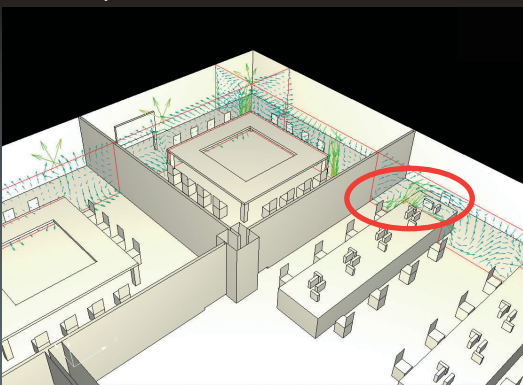

Notes

It is a general request to maintain comfort in indoor environment to keep warm in winter and cool in summer. To obtain such comfort, innovative construction structure or appropriate temperature control by air-conditioning is necessary. On the other hand, energy saving and ecological approaches are being key factors for designing a floor layout in a building. CFD simulation helps improve comfort in the floor as well as energy efficiency and environmental friendliness by calculating and predicting the performance of various design ideas ahead of time.